



Color Variants

AL400791
Stainless steel
Width 90 cm

Installation Accessories

AA010410
Air exhaust grille recirculation mode

| |
|------------------------------|
| AL400791 |
| Table ventilation 400 series |
| Stainless steel |
| Width 90 cm |
| Air extraction/recirculation |
| Motorless |

Extendable table ventilation, when not in use can be completely lowered into the worktop
Can be combined perfectly with other 400 series Vario appliances
Precision crafting of 3 mm stainless steel
For surface installation with a visible edge or for flush installation
Motorless, can be combined with Gaggenau BLDC remote fan units

Output

Power levels depend on the remote fan unit.

Features

Interval ventilation, 6 min.
Run-on function, 6 min.
Grease filter saturation indication by flashing light
Cartridge-type filter, dishwasher-safe.
Illuminance 200 lx.
Spare covers for closing air outlets.
No duct connection piece included.

Planning notes

Refer to the table on page XX for the matching remote fan units for air recirculation or air extraction mode.
Connection to the respective appliances via network cable.
For operation with 2 appliances 400 series or a cooktop configuration of up to 92 cm wide.
Operation of Vario cooking appliances only possible without appliance cover.
Max. output of cooktops 18 kW.
In combination with the cooktop CI 490, installation in 2 3/8" deep countertops is possible.
If the remote fan unit is installed within the bottom cabinet and if combined with VK or VF ensure accessibility to the outlets.
Installation is possible in worktops made of stone, synthetics or solid wood. Heat resistance and watertight sealing of the cut edges must be observed. Concerning other materials please consult the worktop manufacturer.
Ovens that do not exceed the maximum allowed cabinet temperature can be combined with the table ventilation if built-in situation permits.
To avoid smoke when frying/grilling refer to the manuals of VR/VP.
When installing a ventilation hood with air extraction mode and a chimney-vented fireplace, the power supply line of the ventilation appliance needs a suitable safety switch.

Rating

Total connected load 65 W.
Connecting cable 1.7 m, pluggable.
Network cable 1,2 m.
The remaining surface of the worktop (min. 50 mm) between the cut-outs must be reinforced with a support. It is recommended to use furniture support AA 409 401/431.
Lamp output 4 x LED 6medium power 5W stripe.
Dimmable, neutral white surface LED light for ideal illumination of the whole cooktop
Neutral white surface LED light (3600 K), continuously dimmable.

| |
|-------------------------------------|
| Product Features |
| Operating Mode |
| Convertible: Ducted / Recirculating |
| Number of speed settings |
| 3-stage |
| Delay Shut off modes |
| 6M |
| Silence level (dBA) |
| Required accessories |
| Blower |
| Optional accessories |
| AA400510 |
| Number of lights |
| 4 |
| Type of lamps used |
| LED |
| Total power of the lamps (W) |
| 20 |
| Grease filter material |
| Washable stainless steel |
| Grease filter type |
| Multilayer cassette |
| Clean filter reminders |

Consumption and connection features

| |
|--|
| UPC code |
| 825225910251 |
| Material |
| Stainless steel |
| Watts (W) |
| 65 |
| Current (A) |
| 10 |
| Volts (V) |
| 100-120 |
| Frequency (Hz) |
| 60 |
| Approval certificates |
| VDE |
| Power cord length (in) |
| 66,93 |
| Power cord length (cm) |
| 170 |
| Plug type |
| 120V-3 prong |
| Overall appliance dimensions (HxWxD) (in) |
| 21 1/4 " - 34 1/4 " / 21 1/4 " - 34 1/4 " x 35 3/4 " x 5 1/2 " |
| Overall appliance dimensions (HxWxD) (mm) |
| 540-870 x 908 x 140 |
| Product packaging dimensions (HxWxD) (in) |
| 14.96 x 24.99 x 40.55 |
| Adjustable feet |
| Height of the chimney (in) |
| Height of the chimney (mm) |
| Vertical rise height |
| 0 "-13 " |
| Required distance above cooktop/ ranges |
| Net weight (lbs) |
| 73 |
| Net weight (kg) |
| 33.0 |
| Gross weight (lbs) |
| 84 |
| Gross weight (kg) |
| 38.0 |
| Motor location |
| External motor |
| Maximum CFM |
| Diameter of air duct (in) top |
| Diameter of air duct (in) back |
| 6 |
| Discharge direction |
| horizontal |
| No-return airflow flap |
| No |
| 2016-11-03 |
| Page 1 |

3 electronically controlled power levels and an intensive mode.

AL400791

Table ventilation 400 series

Stainless steel

Width 90 cm

Air extraction/recirculation

Motorless

2016-11-03

Page 2

AL 400 connection positions $\varnothing 6''$

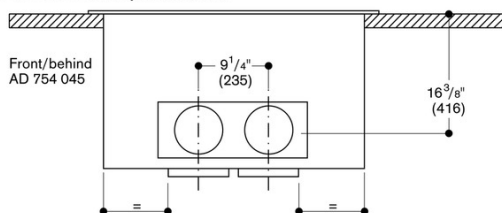

AD 754 045

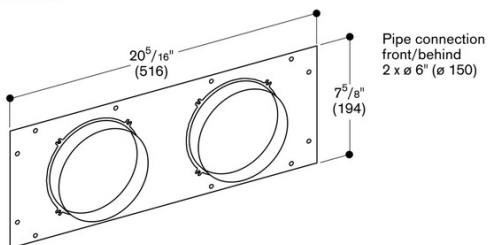

Cross-section

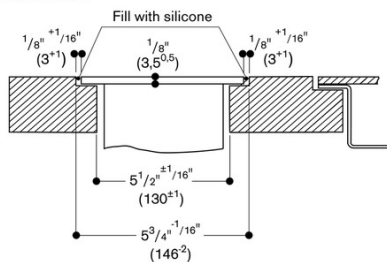

Longitudinal section

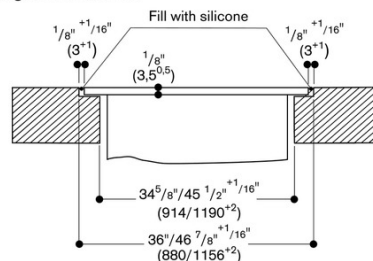

AA 409 401/431 cabinet support

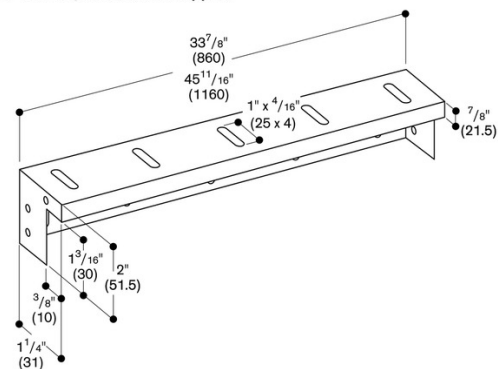

AL 400 mounted flush

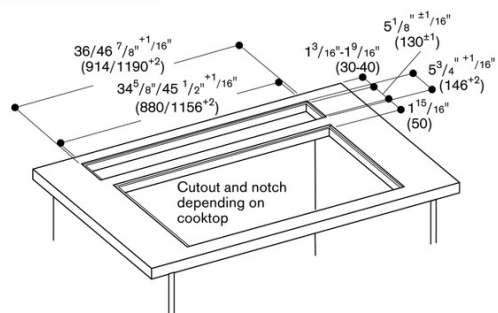

AL400791

Table ventilation 400 series

Stainless steel

Width 90 cm

Air extraction/recirculation

Motorless

2016-11-03

Page 3

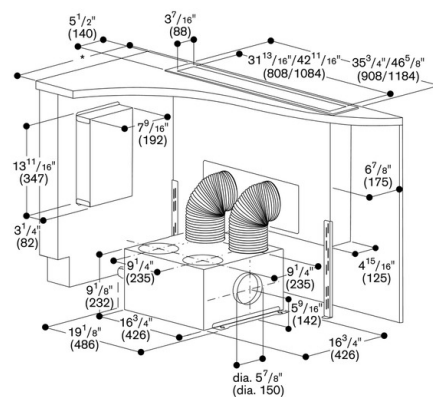
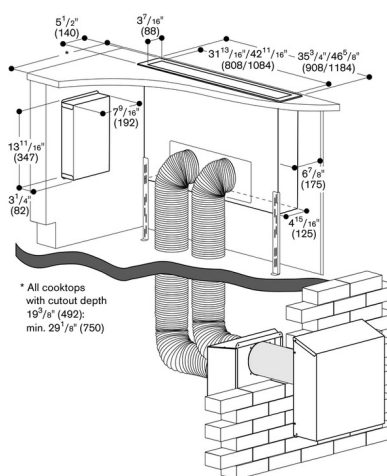
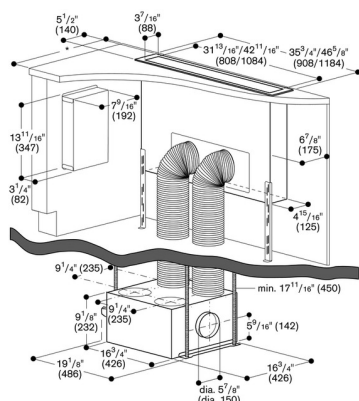
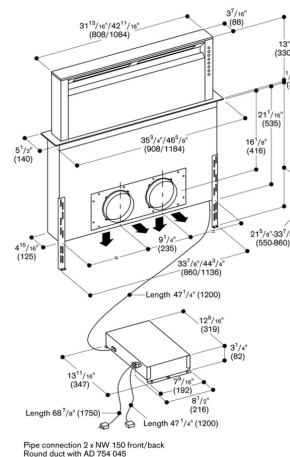

* All cooktops with cutout depth 19 3/8" (492); min. 29 1/8" (750)

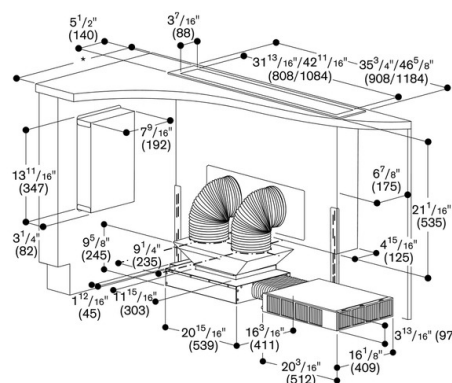

* All cooktops with cutout depth 19 3/8" (492); min. 29 1/8" (750)

GAGGENAU